

Life...Enjoy the Ride Messenger Bag

Tina Higgins



Designed By: Heidi Pridemore
Skill Level: Beginner
Finished Size: 15" wide x 12" tall x 4" deep



23443 K



23440 E

FABRIC REQUIREMENTS	
Design	Yards
23443 K	1
23440 E	1
Fusible Fleece	1

Designer Notes

- The outer bag and straps are made with Fabric A (gray wheels print).
- The inner pocket is made with Fabric A (gray wheels print) and is sewn to the front or back of the inside lining. There is enough fabric to make two pockets, if desired (one for the front and one for the back).
- The outer flap and flap lining are made with Fabric B (tossed bikes print).

Cutting Instructions

Note: A widthwise cut (WOF) is from selvage to selvage.

23443 K: Fabric A (gray wheels print)

- Cut (1) 8" x **WOF** strip for the strap.
- Cut (1) 6" x **WOF** strip. Subcut (1) 6" x 12" rectangle for the pocket.
- *Following the manufacturer's instructions for the fusible fleece, apply fusible fleece to the wrong side of the fabric before cutting the following Fabric A pieces:*
- Cut (1) 14½" x **WOF** strip. Subcut into (2) 14½" x 19½" rectangles for the outer bag.

23440 E: Fabric B (tossed bikes print)

- Cut (1) 14½" x **WOF** strip. Subcut into (2) 14½" x 19½" rectangles for the lining.
- Cut (1) 15½" x **WOF** strip. Subcut into (2) 15½" x 16½" rectangles for the flap.

Assembly

Flap

1. Cut (1) 15½" x 16½" piece of fusible fleece. With a hot iron, press the wrong side of one 15½" x 16½" Fabric B strip to the fusible fleece to make the outside of the flap (Unit 1).
2. Place right sides together of Unit 1 and remaining 15½" x 16½" Fabric B rectangle. With a ¼" seam, stitch down each long side of the rectangles and across one short side to complete the flap (see Diagram 1). Turn the flap right side out and press.

DIAGRAM 1



Strap

1. Fold one 8" x **WOF** Fabric A rectangle in half lengthwise and press (see Diagram 2, Step 1).

DIAGRAM 2

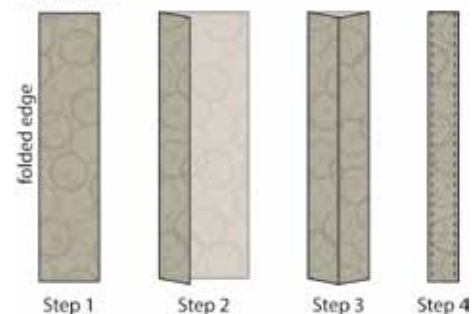

2. Open the folded fabric and fold each long edge to the creased centerline and press (see Diagram 2, Step 2).
3. Fold the pressed fabric in half again and press to make one 2" x **WOF** strip (see Diagram 2, Step 3).
4. Top stitch down both long sides $\frac{1}{8}$ " from the outer edge (see Diagram 2, Step 4).
5. The strap will be one-quarter the original width of the 8" x **WOF** Fabric A rectangle.

Pocket

1. With right sides together, fold the 6" x 12" Fabric A pocket rectangle in half, to make one 6" x 6" pocket. Stitch the folded layers together down the short sides and across the long non-folded side with a $\frac{1}{4}$ " seam, leaving a 2" opening for turning. (see Diagram 3). Turn the pocket right side out, making sure to turn the opening edges under $\frac{1}{4}$ " and pressing all seams.

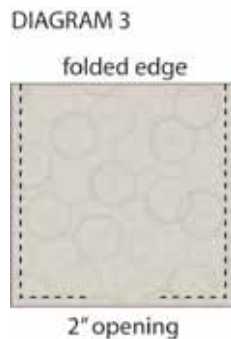

2. Center the pocket on the right side of a 14 $\frac{1}{2}$ " x 19 $\frac{1}{2}$ " Fabric B lining rectangle with the long sides of the pocket parallel to the long sides of the lining piece. The pocket should be positioned approximately 6 $\frac{1}{2}$ " from each short side and 6" from each long side (see Diagram 4). With top thread matching Fabric B, top stitch down both short sides and across the non-folded edge $\frac{1}{8}$ " from the outer edge of the pocket, making sure to close the turn opening.

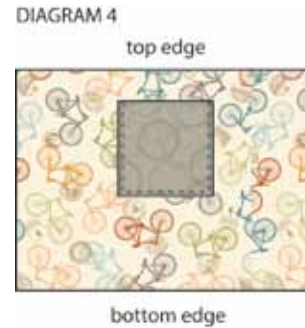

Lining and Outer Bag

1. Place the two 14 $\frac{1}{2}$ " x 19 $\frac{1}{2}$ " Fabric B lining rectangles right sides together. With a $\frac{1}{4}$ " seam, stitch down the two short sides and across the long side closest to the bottom edge of the pocket, leaving a 4" opening for turning.
2. Referring to Diagram 5, measure in 2" from each side edge and 2" up from the bottom edge of the lining unit. Cut out the two 2" x 2" corner squares of fabric.

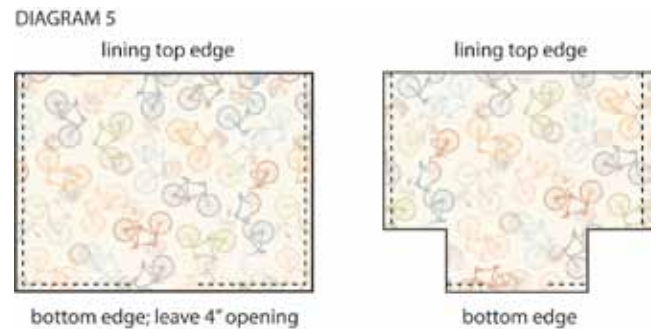

3. To make the bottom box-shape of the lining, open the Lining Unit and align the bottom edge with the side edge and with a $\frac{1}{4}$ " seam, sew the two right-side edges together (see Diagram 6). Repeat with the opposite bottom corner. Lining Unit is completed.



- Repeat steps 1–3 with the two 14½" x 19½" Fabric A Outer Bag rectangles to make the Outer Bag Unit however do not leave a 4" opening on the long (bottom) edge of the Outer Bag Unit (see Diagram 7).

DIAGRAM 7

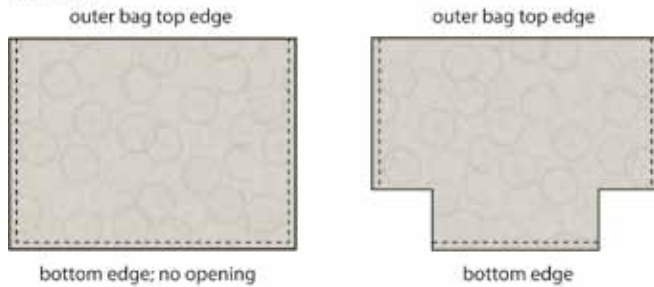

Bag Assembly

- With right sides together, pin the strap ends to each side of the Outer Bag, aligning the short raw edge of the strap with the short raw edge of the bag directly above the bottom corners (see Diagram 8). Check the length of the strap and if it is too long, unpin one side, trim to the desired length, and repin the strap in place.

DIAGRAM 8



- With the right sides together, position and pin the Flap to the back rectangle of the Outer Bag Unit, and aligning the raw edges (see Diagram 9). The outside/fleece side of the Flap should face the right side of the Outer Bag Unit.

DIAGRAM 9



- Make sure the handles and flap are hanging down on the right side of the Outer Bag Unit while assembling. Place the Outer Bag Unit, with strap and flap, right sides together with the Lining Unit, aligning the top raw edges of the bag, flap, strap and lining. Pin all raw edges together. With a ¼" seam, sew the Lining Unit and Outer Bag Unit together, reinforcing the stitching at each strap end.
- Turn the bag and lining right side out through the 4" opening in the lining. Press as needed and top stitch the 4" opening in the lining closed. Tuck the lining into the outer bag, making sure to align the sides and bottom.